

Nordic Outswing Door



Beautiful
Enduring
Revolutionary

H
WINDOW

Enter in.

Enter into a new standard for quality. Employing our revolutionary aluminum - wood composite construction, the Nordic Outswing Door is packed with innovation to maximize views yet still achieve high thermal efficiency. Unrivalled performance, beauty, and design flexibility for residential and commercial projects.

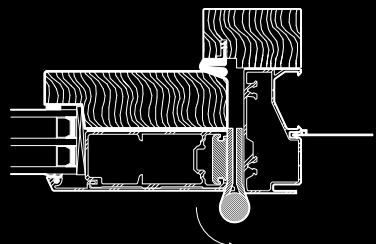

Why swing outwards?

Swinging the Nordic door outward yields two key design advantages. First, by opening the door outwards, precious interior floor space is saved. Second, the weather seal performs better because the harder the wind blows the tighter the seal becomes. The reduced air infiltration saves energy and improves comfort.

Built-In Quality



The Nordic Door is designed for longevity and ease of maintenance.

A dry-glazed system creates less stress on seals and allows glass to be easily replaced. The glazing system is vented and drained to ensure dissipation of any moisture, preventing wood degradation over time.

A wide array of high-tech, high performance double and triple-pane glass can be accommodated.

A unique wind brake guide mechanism allows the active leaf to be locked in any open position. To prevent frame sagging, a fourth hinge is added toward the top of the door where gravity forces are greatest. The 3-point locking mechanism provides the ultimate in security.



Sizing Guide



Rule of Thumb:

The maximum area of a single door is 28 ft² and 57 ft² for a double door.

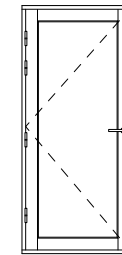

Single Door

Min width: 24" without wind brake
Min height: 78"

Max width: 42" or 48" with continuous gear hinge
Max height: 120"
Max area: 28 ft²

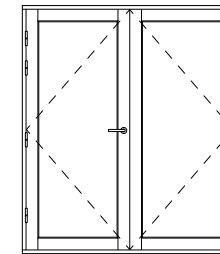

Paired Door/Operable Sidelites

Note: Widths of door leaves can be unequal.

Min width: 36"
Min height: 78"

Max width: 76" with continuous hinge
Max height: 120"
Max area: 57 ft²

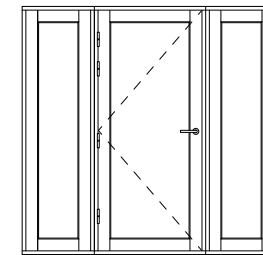

Fixed Sidelites

Note: Fixed sidelites are field mullered for single and paired doors. Each sidelite can be any size up to 60 ft² without exceeding 96" in both directions.

Styling Guide



Every Nordic Outswing Door is custom built, affording an abundance of design freedom.

Interior wood frames are available in a variety of hardwood, softwood, and bamboo species. Factory applied wood finishes include standard or custom paints, stains, and clear coats.

Exterior aluminum finishes available in anodized, powder coated, and Kynar® paint.

Retractable insect screens are available.

Select from a wide variety of standard and premium hardware styles and finishes.



Performance Data

Air, Water, & Structural Performance	Performance Class and Grade Rating AAMA CW-PG40	Water Penetration Resistance Rating ASTM E547 6.0 psf	Air Infiltration Resistance Rating ASTM E283 <0.02 cfm/ft ² at 6.2 psf	Forced Entry ASTM F842 Pass	ADA Compliance < 5 lbs Yes, with ADA hardware & Threshold
Thermal Performance	Glazing Type 3-Pane Argon Fill Low E	U-Factor (Total Unit) NFRC 0.25 Btu/(hr ft ² °F)	SHGC Window NFRC 0.19	CRF Rating Class NFRC up to 61	VLT NFRC 32%

Testing Notes: Results based on lab testing; AAMA reduction for field testing should be applied when tested in the field.



PROJECT PHOTOS: ©PHIL AARRESTAD (FRONT, INSIDE) ©GAFFER PHOTOGRAPHY (BACK)



CONTACTS:

HWINDOW.COM

800-843-4929

401 17th AVENUE WEST
ASHLAND, WI 54806
USA

